

A-5311 FRONT PANHARD BAR

This kit CAN NOT be used with modern cylinder style shock absorber kits

- 1) Attach the frame mounting bracket per illustration "A". This bracket gets sandwiched between the original shock absorber and the frame rail using your original shock mounting bolts, nuts, and lock washers. If your car does not have the original shock absorbers on it, we have included two 7/16 x 1" hex head bolts, nuts, and lock washers to attach the bracket.

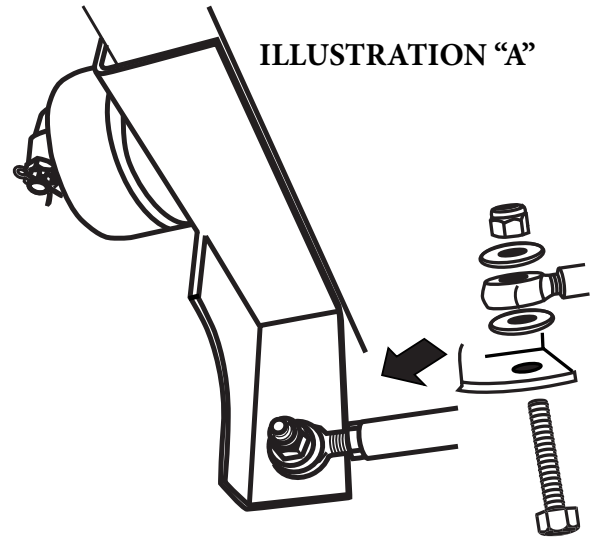

ILLUSTRATION "A"

- 2) The bracket for the other end of the panhard bar will attach to the right side spring shackle per illustration "B". Remove the two cotter pins and castle nuts holding the shackle plate to the back side of the leaf spring/perch. Replace the shackle plate with the panhard bar mounting bracket per the illustration. Replace the castle nuts and install new cotter pins supplied in the kit.

ILLUSTRATION "C"

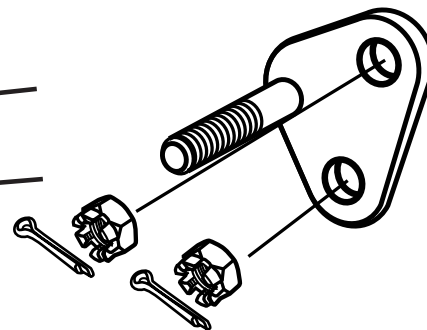
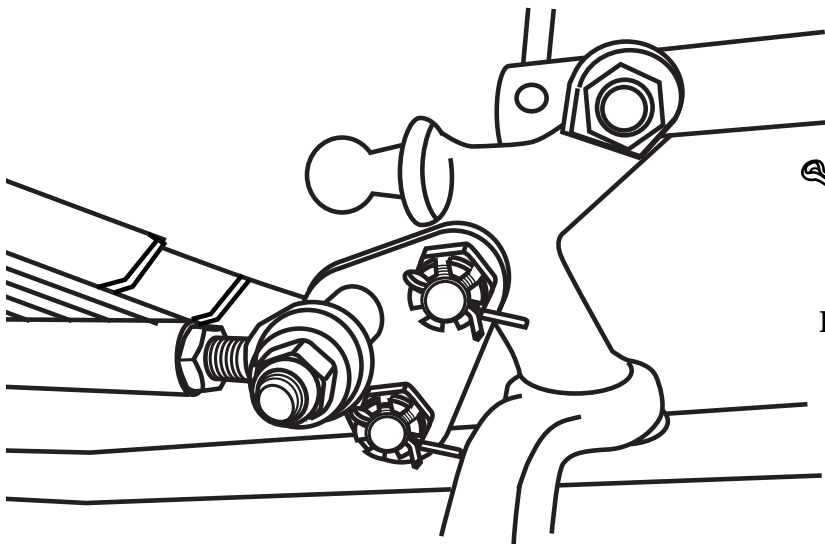
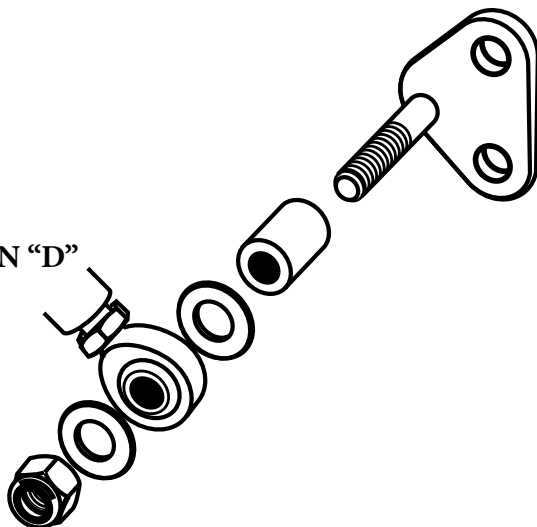

ILLUSTRATION "B"

ILLUSTRATION "D"



- 3) The next step is to attach the panhard bar to the brackets. Attach bar per illustrations "C" and "D". It may be necessary to adjust the eyelets in or out to align the mounting hardware. Adjust an even amount on both ends. Once all hardware is tightened, tighten the jam nuts to lock the eyelets on both ends of the panhard bar.